

**A5-R**  
**5 inch Remodel Non-IC Recessed**  
**Housing**

<b>Catalog #</b>		<b>Prepared by</b>	LiteHarbor
<b>Project</b>		<b>Date</b>	
<b>Notes</b>			

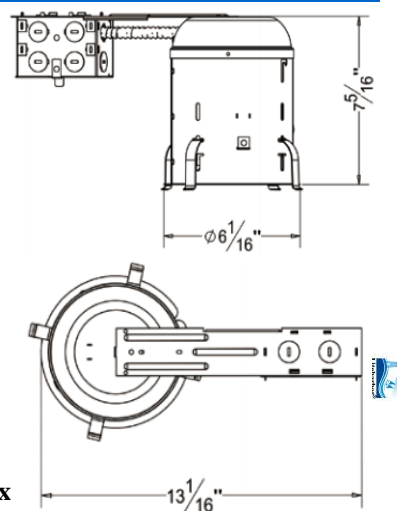

**5 inch Remodel Non-IC Recessed Housing**

**Housing**

- 1) Die-formed aluminum for maximum heat dissipation and rust protection
- 2) Designed for Remodel installation
- 3) Housing can be installed in 1/2" to 1-3/8" thick ceilings.
- 4) Housing is Non-IC rated must be kept at least 3" away from insulation

**Junction Box**

- 1) ETL listed for through branch wiring
- 2) 4 in-4 out J-box
- 3) Designed for straight through conduit runs
- 4) 1/2" and 3/4" romex wiring knockouts

**Lamp**

See trim for max. wattage and lamp

CRI>80%

PF>0.9

Color Temperature:2700K-6500K

**Listing**

ETL listed for damp location W/Feed through

**Order Matrix**

<b>A</b>	<b>B</b>	<b>C</b>	<b>D</b>	<b>E</b>
----------	----------	----------	----------	----------

**Item No.:A5-R**

<b>A</b>	<b>Series</b>
A5-R	5"/ Remodel NON-IC Housing

<b>B</b>	<b>Input Voltage</b>
120V	
277	277V

<b>C</b>	<b>Lamp</b>
P30	PAR30
R30	R30
A19	A19

<b>D</b>	<b>Wattage</b>
L12	LED 12W
L18	LED 18W



**Liteharbor Lighting Technology Co., Ltd.**

New Industry Area Hecun Danzao Town  
 Nanhai Foshan City Guangdong China

TEL: +86-757-8180 8675

FAX: +86-757-8180 8685

E-mail: info@liteharbor.com

Website: www.liteharbor.com

Specifications subject to change w/o notice

Revision: Jan. 2015

Other Special requirement please confirm with factory

E	Color Temperature
28K	2800k
35K	3500K
50K	5000K
60K	6000K



RECESSED DOWNLIGHT



**Liteharbor Lighting Technology Co., Ltd.**

New Industry Area Hecun Danzao Town

Nanhai Foshan City Guangdong China

TEL: +86-757-8180 8675

FAX: +86-757-8180 8685

E-mail: [info@liteharbor.com](mailto:info@liteharbor.com)

Website: [www.liteharbor.com](http://www.liteharbor.com)

Specifications subject to change w/o notice

Revision: Jan. 2015

## 5" TRIM OPTICS



**B5001**

**5" Baffle Trim**

**Lamp:** R30/PAR30 LED E26 18W Max.



**B5002**

**5" Reflector Trim**

**Lamp:** R30/PAR30 LED E26 18W Max.



**B5003**

**5" Eyeball Trim**

**Lamp:** R30/PAR30 LED E26 18W Max.



**B5003L**

**5" Large Eyeball Trim**

**Lamp:** R30/PAR30 LED E26 18W Max.

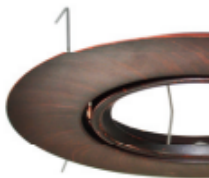

**B5007**

**5" Gimbal Ring Trim**

**Lamp:** R30/PAR30 LED E26 18W Max.



**B5011**

**5" Cone Baffle Trim**

**Lamp:** A19 LED E26 12W Max.

RECESSED DOWNLIGHT



**B5011K**

**5" Baffle Trim**

**Lamp:** R30/PAR30 LED E26 18W Max.



**B5021**

**5" Clear Reflector Trim with Baffle**

**Lamp:** A19 LED E26 12W Max.



**B5022**

**5" Cone Reflector Trim**

**Lamp:** A19 LED E26 12W Max.



**B5300**

**5" Shower Trim with Fresnel Lens**

**Lamp:** A19 LED E26 12W Max.

Gasket used to prevent moisture  
Wet location listed



**Liteharbor Lighting Technology Co., Ltd.**

New Industry Area Hecun Danzao Town  
Nanhai Foshan City Guangdong China

TEL: +86-757-8180 8675

FAX: +86-757-8180 8685

E-mail: info@liteharbor.com

Website: www.liteharbor.com

Specifications subject to change w/o notice

Revision: Jan. 2015



#### B5400

##### 5" Shower Trim with Albalite lens

**Lamp:** A19 LED E26 12W Max.

Gasket used to prevent moisture

Wet location listed



#### B5500

##### 5" Shower Trim with Drop Opal

**Lamp:** A19 LED E26 12W Max.

Gasket used to prevent moisture

Wet location listed



#### B5602

##### 5" Shower Trim with Dome Lens

**Lamp:** A19 LED E26 12W Max.

Gasket used to prevent moisture

Wet location listed



#### B5700

##### 5" Shower Trim with Centre Frosted Lens

**Lamp:** A19 LED E26 12W Max.

Gasket used to prevent moisture

Wet location listed



#### B5800

##### 5" Shower Trim with Frosted Lens

**Lamp:** A19 LED E26 12W Max.

Gasket used to prevent moisture

Wet location listed

RECESSED DOWNLIGHT



**Liteharbor Lighting Technology Co., Ltd.**

New Industry Area Hecun Danzao Town

Nanhai Foshan City Guangdong China

TEL: +86-757-8180 8675

FAX: +86-757-8180 8685

E-mail: info@liteharbor.com

Website: www.liteharbor.com

Specifications subject to change w/o notice

Revision: Jan. 2015