

# BL8-FM9 & BL8-SFM9 9" LED Flush Mount

Catalog #	Prepared by	LiteHarbor
Project	Date	
Notes		



**BL8-FM9**



**BL8-SFM9**

## ORDER MATRIX | Example:BL8-FM9

<u>A</u>	<u>B</u>	<u>C</u>	<u>D</u>	<u>E</u>	<u>F</u>	<u>G</u>
A	Series					
BL8-FM9	9" Round LED Flush Mount					
BL8-SFM9	9" Square LED Flush Mount					
B	Input Voltage					
	120V					
277	277V					
U	120-277V					
C	Dimmable					
	Non-Dimmable					
DM	Dimmable					
D	LED Available					
Cree	Cree					
Citizen	Citizen					
Epistar	Epistar					
Seoul	Seoul					
Osram	Osram					

## Description

An architecturally pleasing, easy to install and low profile slim LED instant mount round and square aperture downlighting.

Slim line, light weight and sleek look, provides more uniform light and an instant on.

It is a low profile downlight intended for ceiling or wall mount applications.

This luminaire offers the appearance of a recessed downlight but is actually surface mounted.

## Applications

Slim LED Flush Mount Downlight is characterized by a completely flat lens with a narrow flange, giving it an architecturally pleasing look.

This downlighting solution offers an affordable alternative to Air-Seal IC recessed housings or Fire-Rated boxes, reducing material and installation costs.

## Features

LED 9" flush mount

Decorative flush mount LED fixture

18.5W Equal to a traditional 100W lamp



LED CEILING LIGHT



**Liteharbor Lighting Technology Co., Ltd.**  
New Industry Area Hecun Danzao Town  
Nanhai Foshan City Guangdong China

TEL: +86-757-8180 8675  
FAX: +86-757-8180 8685  
E-mail: info@liteharbor.com

Website: www.liteharbor.com  
Specifications subject to change w/o notice  
Revision: Jan. 2015

E	Lumen Output
BL8-FM9	1180 Lumen
BL8-SFM9	1190 Lumen

F	Color Temperature
27K	2700K
40K	4000K
50K	5000K
60K	6000K
	Tunable (3000K, 4000K, 5000K, choose any 2 of them)

G	Emergency System
	Without Emergency Battery Backup
EM	With Emergency Battery Backup

84% energy savings  
 Damp location listed  
 Mounts directly to 3" and 4" junction boxes  
 Easy to install

**Finish**

Available in White, Brushed Nickel, and Bronze

**Application**

Residential  
 Office  
 Retail  
 Hospitality

**Listing & Warranty**

ENERGY STAR

2-Year Limited Warranty

**Dimensions**

Ø: 9"xH:1"

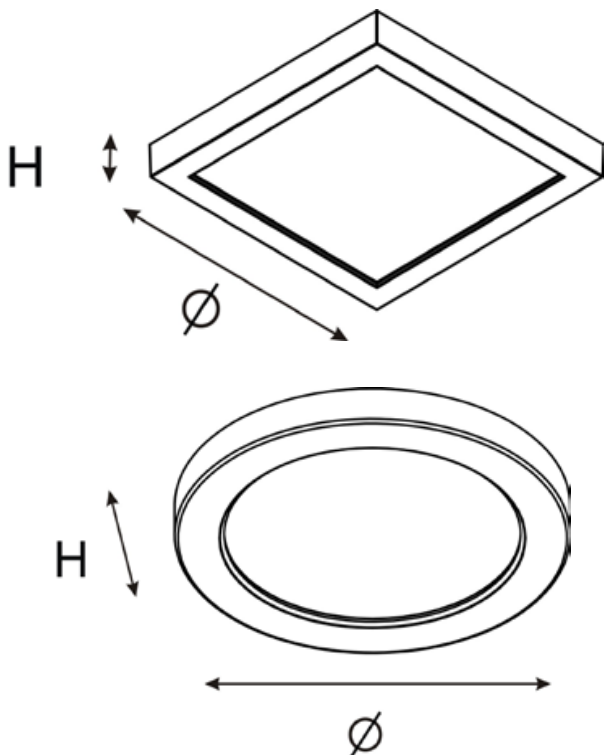

**Light Distribution**

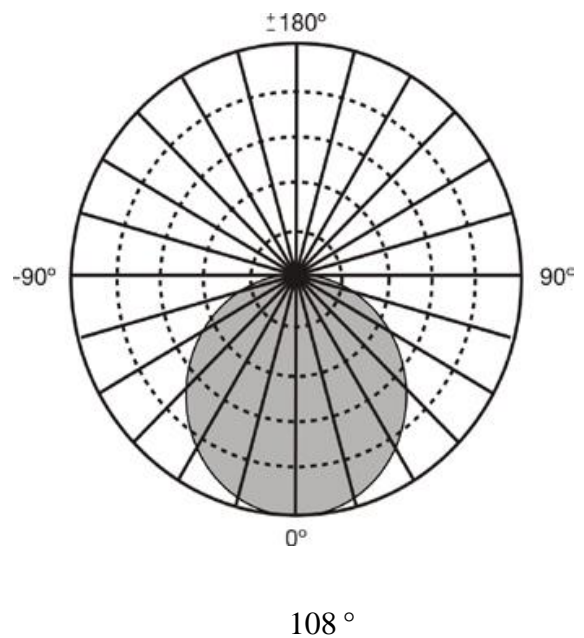

## Emergency

24 hours recharge time  
>90 minute operation from battery  
over-charge/discharge protection

## Dimensions

Ø: 9"xH:2 3/16"

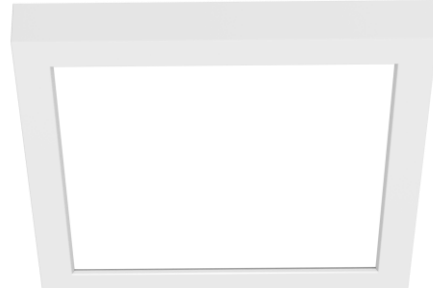

## Installation Instruction

### Fast and Easy Installation

- Mounts directly to any 3" and 4" junction boxes
- The quick connector makes easy and fast connection, the universal mounting plate ensure a clean and tight fit.



Simply screw the unique design universal mounting plate to the junction box



Make your connections using the quick connect included, and fit into place.



Snap the fixture onto the mounting plate.

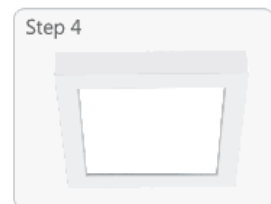

Installation finished, Enjoy the sleek ceiling.

## Ordering Guide

Series	Input Voltage	Dimmable	CCT	Finish	Emergency System
<input type="checkbox"/> <b>BL8-FM9</b> 9"Round LED Flush Mount	<input type="checkbox"/> 110V <input type="checkbox"/> 277V <input type="checkbox"/> 110V-277V	<input type="checkbox"/> Non-Dimmable <input type="checkbox"/> Dimmable	<input type="checkbox"/> 2700K <input type="checkbox"/> 3000K <input type="checkbox"/> 4000K <input type="checkbox"/> 5000K <input type="checkbox"/> 6000K <input type="checkbox"/> Tunable (3000K, 4000K, 5000K, choose any 2 of them)	<input type="checkbox"/> White <input type="checkbox"/> Bronze <input type="checkbox"/> Satin Nickel	<input type="checkbox"/> Without Emergency Batty Backup <input type="checkbox"/> With Emergency Batty Backup
<input type="checkbox"/> <b>BL8-SFM9</b> 9"Square LED Flush Mount					



**Liteharbor Lighting Technology Co., Ltd.**  
New Industry Area Hecun Danzao Town  
Nanhai Foshan City Guangdong China

TEL: +86-757-8180 8675  
FAX: +86-757-8180 8685  
E-mail: info@liteharbor.com

Website: www.liteharbor.com  
Specifications subject to change w/o notice  
Revision: Jan. 2015

