

BL4-013 LED Retrofit

Catalog #		Prepared by	LiteHarbor
Project		Date	
Notes			

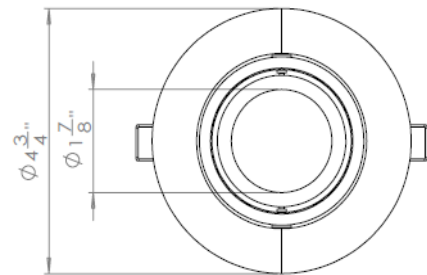
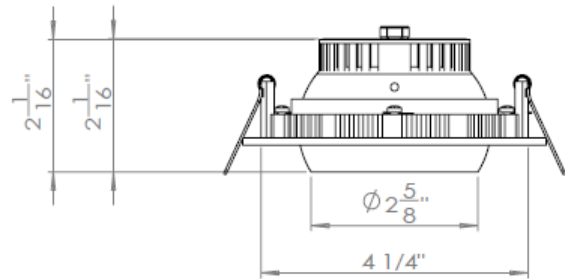

ORDER MATRIX | Example:BL4-013

A	B	C	D	E	F	G
A Series						
BL4-013	4" LED Downlight Module					
B Input Voltage						
	120V					
277	277V					
U	120-277V					
C Wattage						
7.5	7.5W					
11	11W					
D Lumen Output						
600	600 Lumen					
800	800 Lumen					

Description

Round 4" Gimbal fixtures with integral LEDs.
Isolated external driver factory installed inside junction box.
One driver for every fixture required.
IC (Direct Contact with Insulation) Rated Air-Tight

LED Light Engine

120V AC 50/60 Hz (Dimmable)
277V-347V AC 50/60 Hz (Not Dimmable)
600LM / 800LM
LED 7.5W / 11W
Halogen Equivalent 50W
PF > 0.95
40° Beam Angle with 30° tilt and 360° rotation
CCT 2700K / 3000K / 4000K
CRI 80+ / 90+
None Dimmable or TRIAC Dimmable



LED RETROFIT



Liteharbor Lighting Technology Co., Ltd.

New Industry Area Hecun Danzao Town
Nanhai Foshan City Guangdong China

TEL: +86-757-8180 8675

FAX: +86-757-8180 8685

E-mail: info@liteharbor.com

Website: www.liteharbor.com

Specifications subject to change w/o notice

Revision: Jan. 2015

E	Dimmable
	Non-Dimmable
DM	Dimmable

F	Color Temperature
27K	2700K
30K	3000K
40K	4000K

G	LED Available
Cree	Cree
Citizen	Citizen
Epistar	Epistar
Seoul	Seoul
Osram	Osram

Listing & Warranty

ETL listed to US and Canadian standards for damp locations

5-Year Limited Warranty



LED RETROFIT



Liteharbor Lighting Technology Co., Ltd.

New Industry Area Hecun Danzao Town

Nanhai Foshan City Guangdong China

TEL: +86-757-8180 8675

FAX: +86-757-8180 8685

E-mail: info@liteharbor.com

Website: www.liteharbor.com

Specifications subject to change w/o notice

Revision: Jan. 2015