

# DG5003 WALL WASH LIGHT

<b>Catalog #</b>		<b>Prepared by</b>	LiteHarbor
<b>Project</b>		<b>Date</b>	
<b>Notes</b>			



## Order Matrix

A      B      C

<b>Item No. DG5003</b>
------------------------

A	Series
DG5003	Wall Wash Light

B	
Wattage	27/36/40/54W

C	
Voltage	DC-24V

WALL WASH LIGHT

## Features

The appearance of simple, comfortable, unique style, simple yet atmosphere.

Lamp structure, electrical safety in full compliance with EN60598 GB7000 standards.

Waterproof structure design, IP rating reach IP65 or more.

The lamp with a secondary light distribution design, a variety of light distribution angle for choice (8 °15 °30 °45 °60 °90 °), to meet the needs of different scenarios.

Long-life power-driven to ensure the life of 50,000 hours or more, with a short circuit protection, open circuit protection, overheating protection and other multi-protection function to achieve synchronization with the LED lamp life.

## LISTING / WARRANTY

ETL Listed to US and Canadian standards for wet locations  
2 Year LED Limited Warranty



**Liteharbor Lighting Technology Co., Ltd.**  
New Industry Area Hecun Danzao Town  
Nanhai Foshan City Guangdong China

TEL: +86-757-8180 8675  
FAX: +86-757-8180 8685  
E-mail: info@liteharbor.com

Website: www.liteharbor.com  
Specifications subject to change w/o notice  
Revision: May. 2017

## APPLICATION

Suitable for building facades, squares, recreational playgrounds, stage, billboards, rockery, bridges and other contours, illumination of lighting places.



Other Special Requirements please Confirm with Factory

## Dimensions

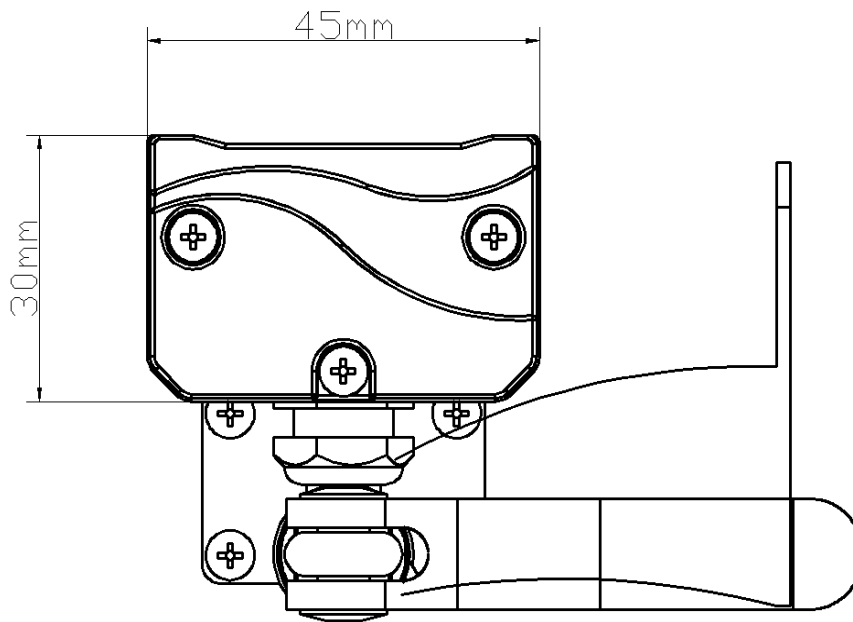

WALL WASH LIGHT



**Liteharbor Lighting Technology Co., Ltd.**  
New Industry Area Hecun Danzao Town  
Nanhai Foshan City Guangdong China

TEL: +86-757-8180 8675  
FAX: +86-757-8180 8685  
E-mail: info@liteharbor.com

Website: www.liteharbor.com  
Specifications subject to change w/o notice  
Revision: May. 2017

## Schematic diagram of structure

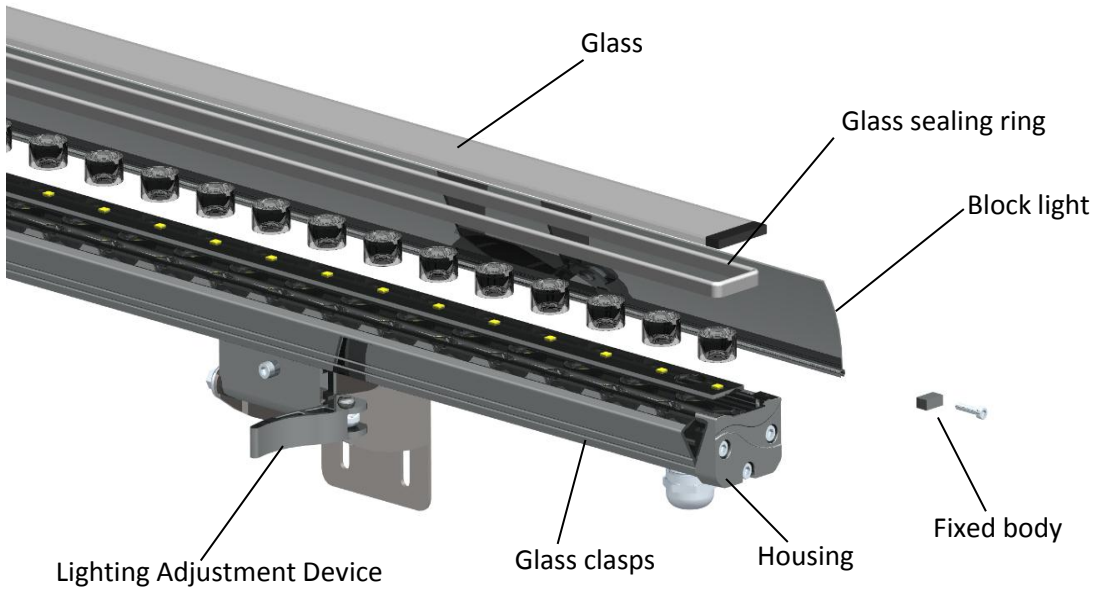

## Light Distribution Curve

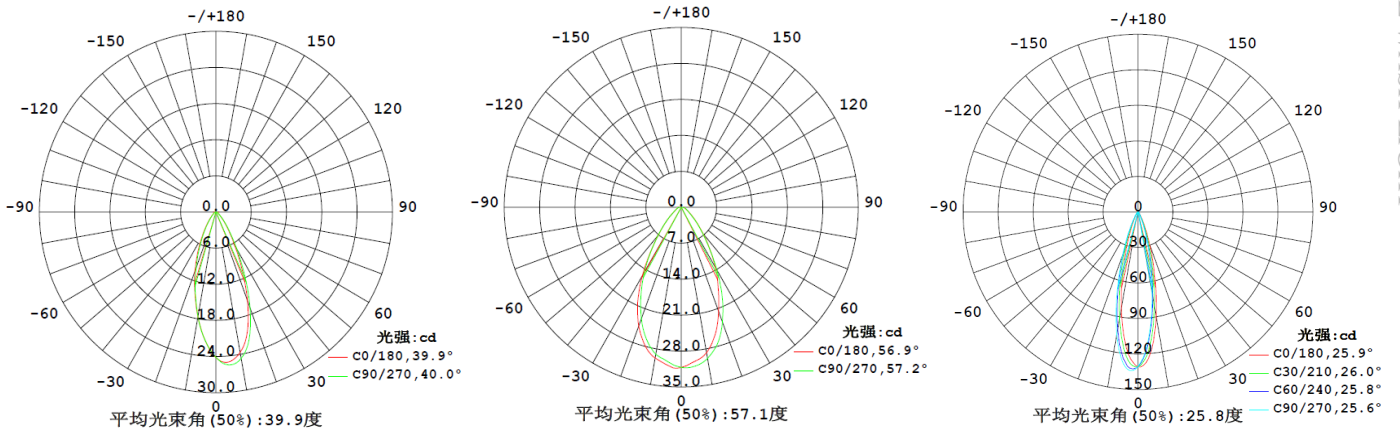

## Famous Brand Light Source



OSRAM



CREE



Lumileds



Sanan optoelectronics



**Liteharbor Lighting Technology Co., Ltd.**  
 New Industry Area Hecun Danzao Town  
 Nanhai Foshan City Guangdong China

TEL: +86-757-8180 8675  
 FAX: +86-757-8180 8685  
 E-mail: info@liteharbor.com

Website: www.liteharbor.com  
 Specifications subject to change w/o notice  
 Revision: May, 2017

## Installation diagram

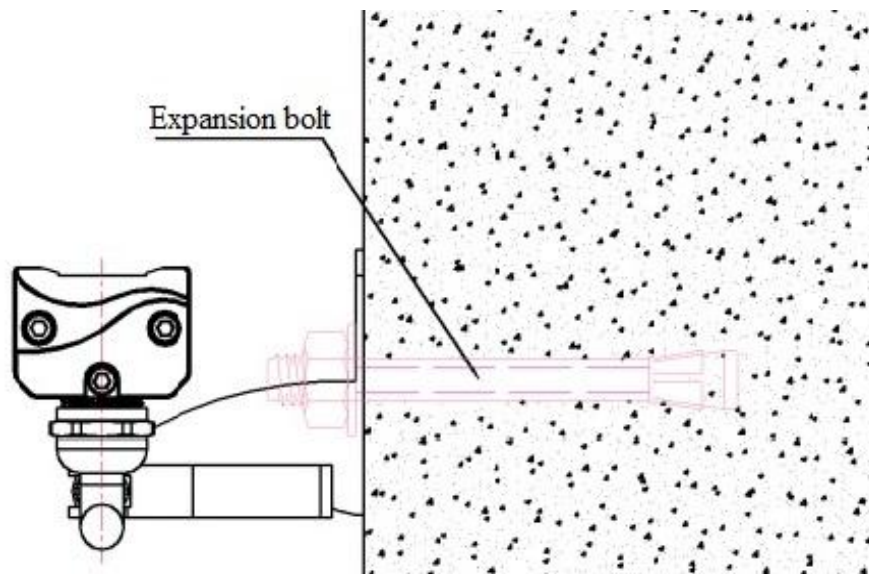

## Ordering Guide

Model	Input Voltage	Single Power	LED QTY	Power	Colour	Optional light	Control Mode
DG5003	DC24V	1W	36 pcs	36W	Monochrome	30/45/60	Centralized Control
DG5003A	DC24V	1.5W	36 pcs	54W	Monochrome	30/45/60	Centralized Control
DG5003B	DC24V	1W	27 pcs	27W	Monochrome	30/45/60	Centralized Control
DG5003C	DC24V	1.5W	27 pcs	40W	Monochrome	30/45/60	Centralized Control
DG5003D	DC24V	1W	36 pcs	36W	RGB	30/45/60	DMX512
DG5003E	DC24V	1.5W	36 pcs	54W	RGB	30/45/60	DMX512
DG5003F	DC24V	1W	27 pcs	27W	RGB	30/45/60	DMX512
DG5003G	DC24V	1.5W	27 pcs	40W	RGB	30/45/60	DMX512
DG5003H	DC24V	1W	36 pcs	36W	RGBW	30/45/60	DMX512
DG5003I	DC24V	1.5W	36 pcs	54W	RGBW	30/45/60	DMX512
DG5003J	DC24V	1W	27 pcs	27W	RGBW	30/45/60	DMX512
DG5003K	DC24V	1.5W	27 pcs	40W	RGBW	30/45/60	DMX512

WALL WASH LIGHT



**Liteharbor Lighting Technology Co., Ltd.**  
 New Industry Area Hecun Danzao Town  
 Nanhai Foshan City Guangdong China

TEL: +86-757-8180 8675  
 FAX: +86-757-8180 8685  
 E-mail: info@liteharbor.com

Website: www.liteharbor.com  
 Specifications subject to change w/o notice  
 Revision: May. 2017