

Pendant Mounted Super Thin LED Mini Spotlight

Catalog #		Prepared by	LiteHarbor
Project		Date	
Notes			



Xiangfei Series Pendant Mounted Super Thin LED Mini Spotlight

Description

Xiangfei X-Light series, it provides a quick and convenient installation method, provides the solution of the edge of architecture lighting, and makes a big breakthrough in the use and design. 1 inch (Ø25mm) of the light-emitting surface the size to achieve the ultimate. Deep housing design with high luminous efficiency, uniform illumination, long life (50000 hours), and glare prevention. Achieve soft lighting without seeing the light source.

Features

- Xiangfei X-light series with square and circular light emission effect.
- Professional light distribution devices, no glare, perfect control light, spot even transition.
- Each series has 1-4 light combinations, providing multiple style options.

Lamp Body

- Ultra thin, the height of the whole lamp is only 23mm .
- Ultra small light emitting surface, only 1 inch (Ø25mm).
- All-in-one die casting lamp body with unique appearance.
- Double-sided heat dissipation, can be made into IC type directly.
- The anti-pull device is hidden inside the lamp body.



Liteharbor Lighting Technology Co., Ltd.

New Industry Area Hecun Danzao Town
Nanhai Foshan City Guangdong China

TEL: +86-757-8180 8687

FAX: +86-757-8180 8685

E-mail: info@liteharbor.com

Website: www.liteharbor.com

Specifications subject to change w/o notice

Revision: Apr. 2018



LED MINI SPOTLIGHT

Light Source

High power, high luminous flux illumination, long life LED chip, 3000K, 4000K, 5000K color temperature are optional, color rendering index: 80+, 90+. Lifetime luminous flux maintenance rate: 70%.

Power Supply

- Wide voltage input 120-277VAC, 50/60 Hz, 0-10V dimming, constant voltage and constant current mode.
- The power has UL listed, can be applied to a variety of applications.
- Integrated power supply, easy to replace the power supply.
- The input voltage of each lamp is 36V, the load termin can be used independently.
- Each luminaire is connected in parallel, one power supply can simultaneously control the use of five lamps.

Accessories

Radiator: It is made of die-casting aluminum material with high thermal conductivity and aluminum alloy. The air convection chamber is reserved inside and outside. It is light, efficient, material-saving, energy-saving, beautiful, and environmentally friendly. It fully considers convection, conduction and radiation of the lamp body. The outer surface is treated with a black surface to ensure sufficient radiation.

Lens: Professional optical PMMA lens.

Round reflector cup: Large lamp shielding angle (60 degrees), effectively preventing glare. Environmental protection electrostatic powder coating surface treatment process, durable wear, avoid stray light, soft and comfortable light.

Mounting

Specially introduced surface mounted, recessed mounted, pendant mounted X-light, simplify installation requirements. And each series has 1-4 light combinations, providing multiple style options.

Applications

Apply to residential, offices, hotels, include the airports, shopping malls, gymnasiums and other high altitude ceiling sites.

Listing / Warranty

ETL listed to US and Canadian standards for damp location.

5 Year Limited Warranty.



Liteharbor Lighting Technology Co., Ltd.

New Industry Area Hecun Danzao Town
Nanhai Foshan City Guangdong China

TEL: +86-757-8180 8687

FAX: +86-757-8180 8685

E-mail: info@liteharbor.com

Website: www.liteharbor.com

Specifications subject to change w/o notice

Revision: Apr. 2018



Lamp

Wattage	16W Max./lamp
Input Voltage	36V
CCT	3000K/4000K/5000K/6500K
CRI	80+/90+
Luminous flux	1400lm/lamp
Light source	LED
Dimming	0-10V Dimming
Life span	100000Hours

Power Supply

Wattage	120W Max .
Input Voltage	120-277V AC
Frequency	50/60 Hz
Output Voltage	36V
Electric current	3.4A Max .
Power Factor	>0.9
Dimming	0-10V Dimming

Ordering Guide

Series	Mounting	Input Voltage	Wattage	Color Temperature
<input type="checkbox"/> X-light	<input type="checkbox"/> Remodel	<input type="checkbox"/> 120V-277V	<input type="checkbox"/> 16W/lamp	<input type="checkbox"/> 3000K
LED Mini Spotlight	<input type="checkbox"/> New Construction			<input type="checkbox"/> 4000K
	<input type="checkbox"/> Surface Mounted			<input type="checkbox"/> 5000K
	<input type="checkbox"/> Recessed Mounted			<input type="checkbox"/> 6500K
	<input type="checkbox"/> Pendant Mounted			
Dimmable	CRI	Light Source	Emission Effect Shape	
<input type="checkbox"/> 0-10V dimming	<input type="checkbox"/> 80+	<input type="checkbox"/> CREE	<input type="checkbox"/> Square	
	<input type="checkbox"/> 90+	<input type="checkbox"/> Citizen	<input type="checkbox"/> Round	
		<input type="checkbox"/> Epistar		
		<input type="checkbox"/> Seoul		
		<input type="checkbox"/> Osram		

*Customized Also Available



Liteharbor Lighting Technology Co., Ltd.

New Industry Area Hecun Danzao Town
Nanhai Foshan City Guangdong China

TEL: +86-757-8180 8687

FAX: +86-757-8180 8685

E-mail: info@liteharbor.com

Website: www.liteharbor.com

Specifications subject to change w/o notice

Revision: Apr. 2018



Dimensions

2 Lamps

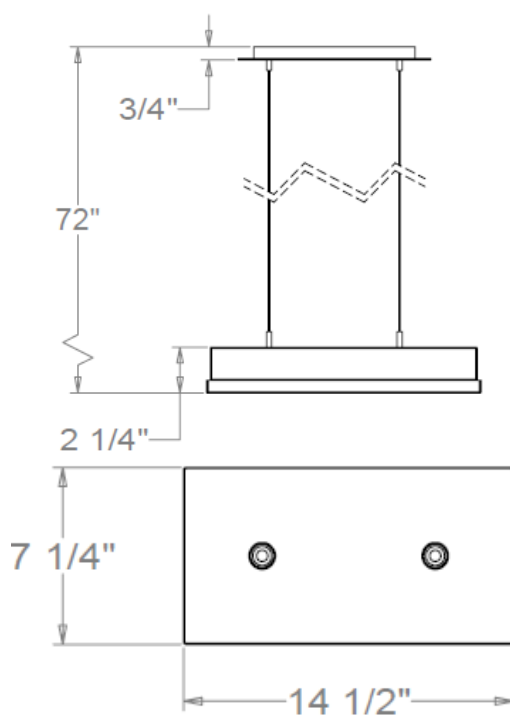

3 Lamps

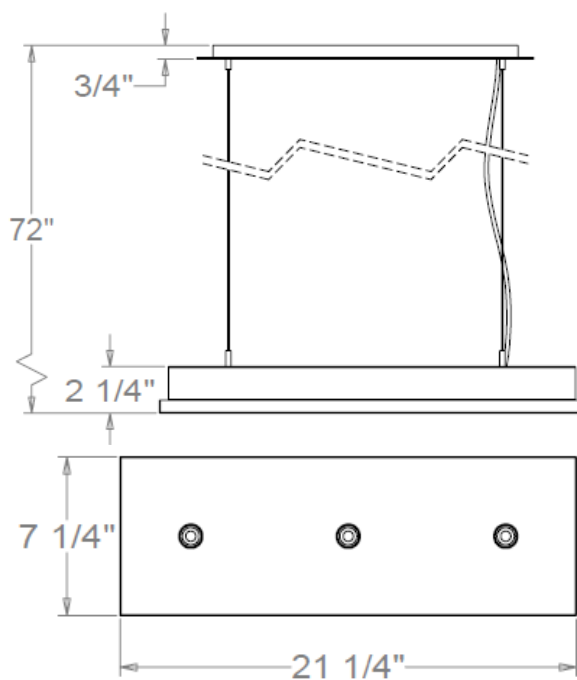

LED MINI SPOTLIGHT



Liteharbor Lighting Technology Co., Ltd.
New Industry Area Hecun Danzao Town
Nanhai Foshan City Guangdong China

TEL: +86-757-8180 8687
FAX: +86-757-8180 8685
E-mail: info@liteharbor.com

Website: www.liteharbor.com
Specifications subject to change w/o notice
Revision: Apr. 2018

4 Lamps

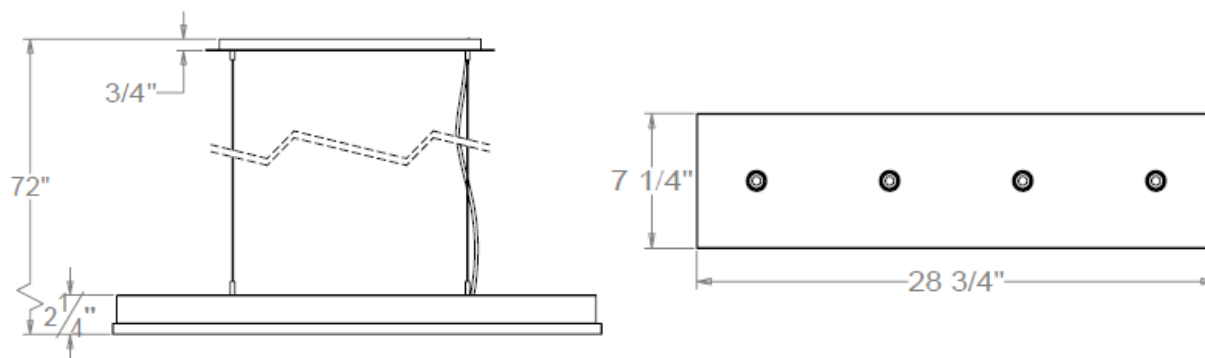

4 Lamps (2x2)

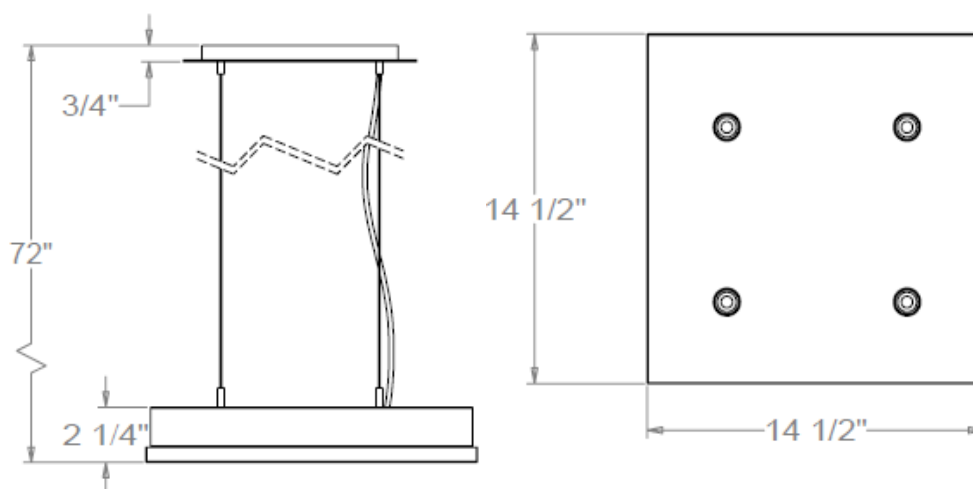

5 Lamps

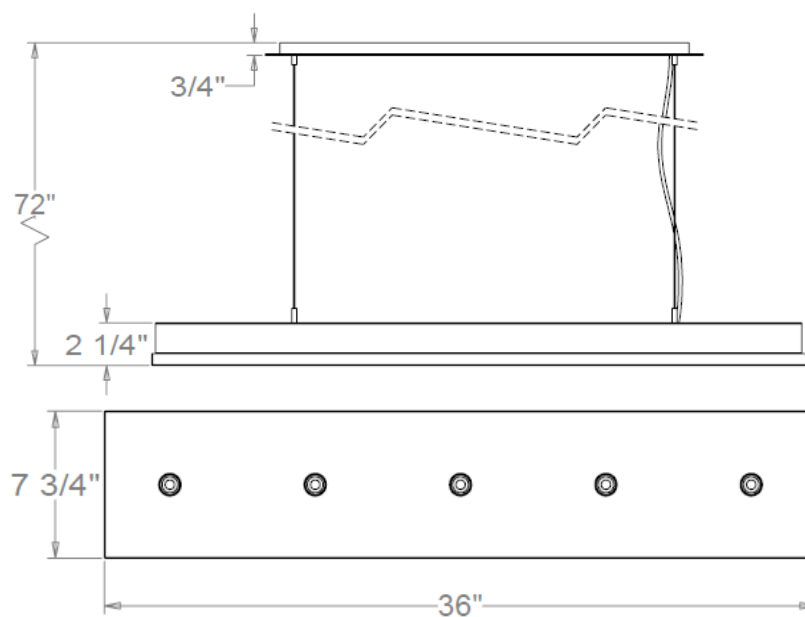

Liteharbor Lighting Technology Co., Ltd.

New Industry Area Hecun Danzao Town
Nanhai Foshan City Guangdong China

TEL: +86-757-8180 8687

FAX: +86-757-8180 8685

E-mail: info@liteharbor.com

Website: www.liteharbor.com

Specifications subject to change w/o notice

Revision: Apr. 2018



Installation

Pendant Mounted



Surface Mounted

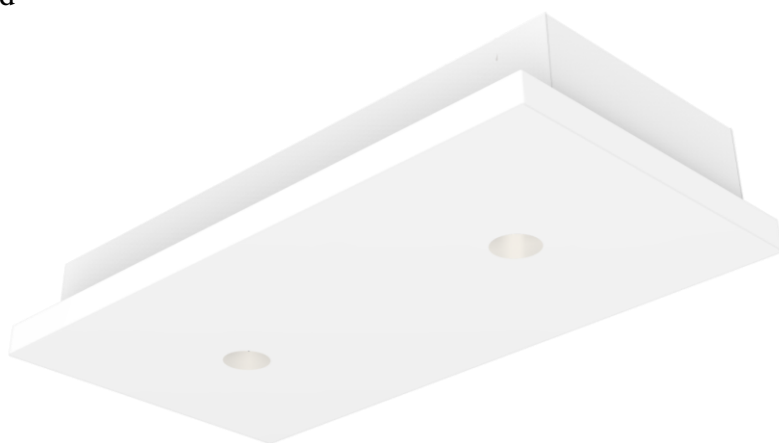

Recessed Mounted



Liteharbor Lighting Technology Co., Ltd.

New Industry Area Hecun Danzao Town
Nanhai Foshan City Guangdong China

TEL: +86-757-8180 8687

FAX: +86-757-8180 8685

E-mail: info@liteharbor.com

Website: www.liteharbor.com

Specifications subject to change w/o notice

Revision: Apr. 2018